

Outdoor Siren with Solar

USER GUIDE

ZIGBEE

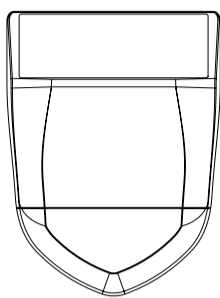

Product Configuration

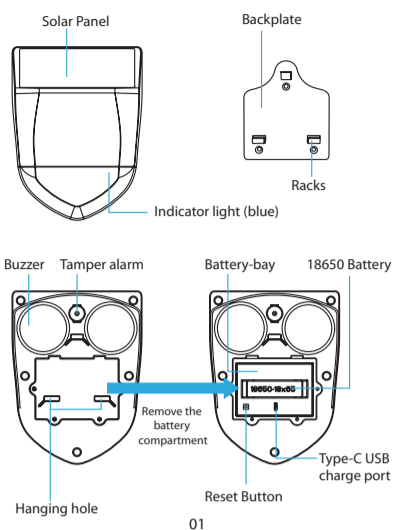

01

Installation Method

- (1) Open the battery compartment and take out the insulating sheet at the battery end
 - (2) Charge through the Type-C port and activate the device
 - (3) Follow the instructions to connect the device to the network and connect to the APP
 - (4) Cover the battery compartment, and use the accessory screwdriver to screw on the screws
 - (5) Use accessory screws to fix the back plate at the installation position
 - (6) Align the hanging hole of the Outdoor siren with the back plate and hang it
- (7)Note:
 ① When installing, please align the solar panel with the position where the sun shines for the longest time.
 ② If there is no sun for two consecutive months, remove the device and charge it through USB.

Type-C power-on activation

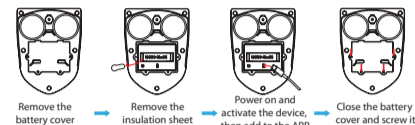

02

1. Backplate installation

- Mark the position of the backplate holes on the wall and drilled
- Align the backplate holes with the wall holes and fix with screws

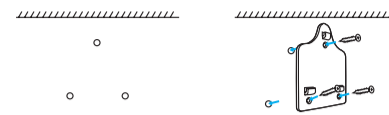

Finish!

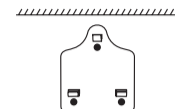

03

- Align the racks on the backplate with the device mounting holes then fix it
- Finish!

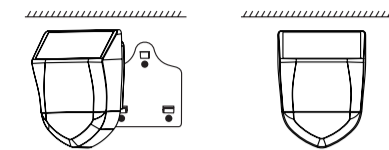

04

3.Type-C USB Charging

- (1) Remove the alarm from the installation
- (2) Remove the screws of the battery compartment and open the hatch cover
- (3) Use 5V/1A power supply to charge the device, and the charging time is 9 hours

Specifications

Power: 5V/1A Type-C USB Powered
 Battery type: 18650 rechargeable batter
 Wireless protocol: Zigbee 3.0
 Zigbee standard: Zigbee IEEE 802.15.4
 Wireless range: 45m(Max)
 Standby current: 2.5mA
 Type of alarm ringtone: 3
 Maximum alarm sound:1M-100dB
 Waterproof rate: IPX5
 Working temperature: -10 C ~ 60 C (14 F ~ 140 F)
 Working humidity: 1% ~ 95%RH(Non condensation)
 Size: 200mm x 150mm x 65.87mm
 Solar panel size: 132mm X 62mm
 Minimum light value for charging: 10000Lux

05

LED State

Device Status	LED State
Configure network mode	Indicator light flashes 2 times in 1s
Indicator light color	Blue
Reset	Long press the rest bottom for 6s

06

Get Started

1. Download APP

Download the "Smart life" app from APP Store or Google Play to your mobile.



2. Register and Login

- 2-1 Launch the "Smart life" app.
- 2-2 To register,enter your mobile phone number or email address,create a password ,then login to the app.
- 2-3 Login if you have an account already.

07

3. Add Devices

3-1. Add ZigBee Gateway

Configure to Tuya gateway, please follow the gateway manual (note the difference between wired gateway and wireless gateway)

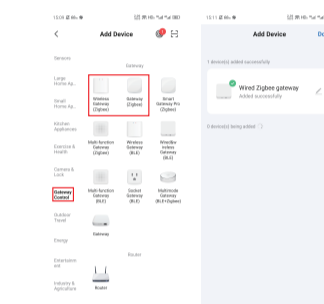

08

3-2. Add Sub-devices(Outdoor Siren)

Please confirm that the device is in the standby state before configuration. If it is not in the standby state, you need to press and hold the reset button for 6 seconds, and the device indicator light will flash and enter the standby state.

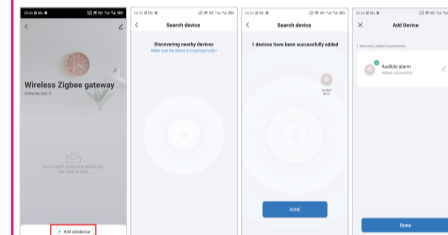

09

Functions and Settings

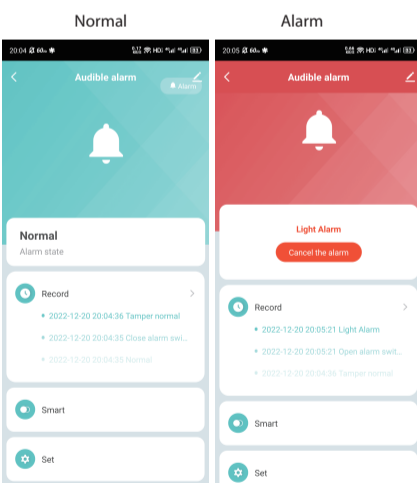

10

1. Alarm State Display

Click to remove the alarm when it is reported.

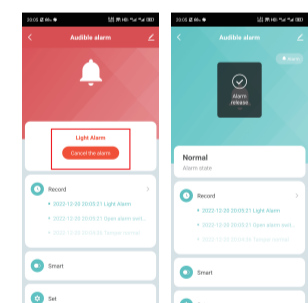

11

2. Record

you can view the alarm history record of the device.

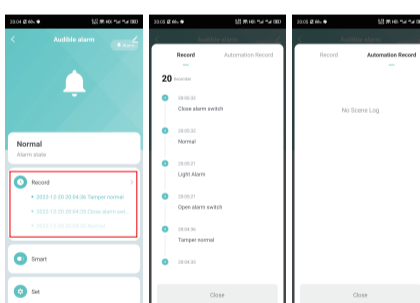

12

3. Smart

Setting smart linkage

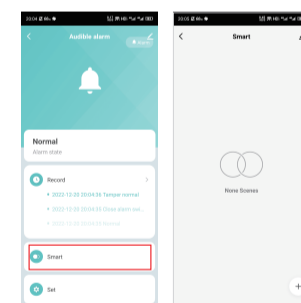

13

4. More Setting

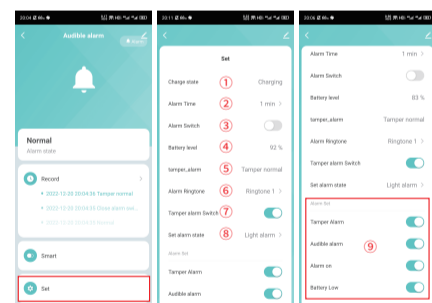

14

① Charge state: Normal state/Charging

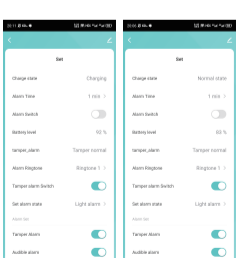

② Set the alarm duration; setting range 1-60min



⑤ Tamper alarm; display the current tamper alarm status



⑥ Alarm ringtone; there are 3 alarm sounds to choose

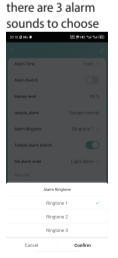

⑦ Tamper alarm ;turn on/off the tamper alarm, and the tamper will not be triggered after closing

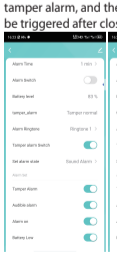

③ Alarm switch; turn on/off the alarm

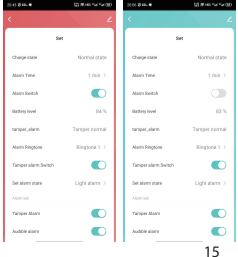

④ Battery level display

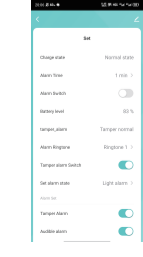

15

⑧ Alarm type

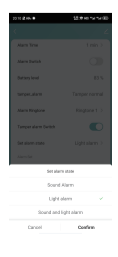

⑨ Alarm off; turn on/off the alarm, you will not receive a push after closing, and the device function will not be turned off

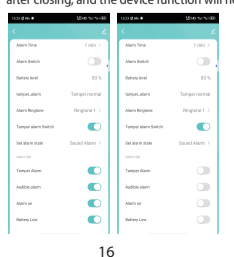

16

Other Function

1. Share device

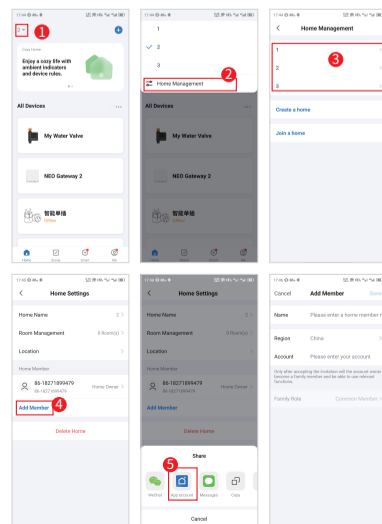

2. Push Notification Setting

If it is disabled, all devices in the APP will not receive notification, but message records will not be affected.

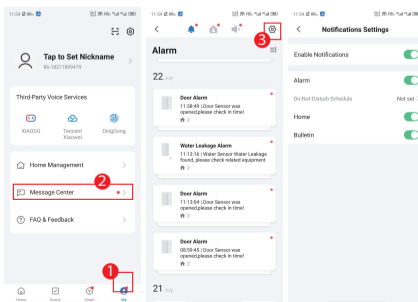

18

3. Remove Device

Wipe data; Delete the device through the APP and add the device again to clear the historical record

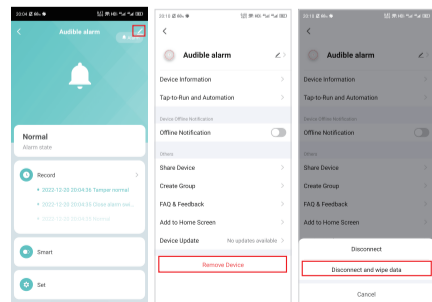

19

Due to the app update, the above interface is for reference only