

SMART WI-FI CAMERA USER MANUAL

4 Add device

- When the indicator light on the device turns from flashing red light to steady green light, the network configuration is complete.

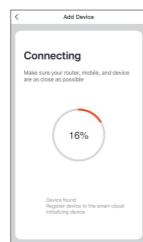

*Please refer to the specific APP interface if there are any difference.

Frequently Asked Questions

1 Can I share with family and friends?

Yes, you can share your cameras with family and friends who will have access to view the camera and control your bulbs, plugs, and other devices. In the app, press the Profile button and click on the "Home Management" button, and you will be able to give or revoke sharing permissions. In order to share, the other user should already have downloaded the app and registered a new account.

2 What's the Wireless Range?

The range of your home Wi-Fi is heavily dependent on your home router and the conditions of the room. Check with your router specifications for exact range data.

3 How many cameras can I control?

TuyaSmart app can control an unlimited amount of devices in an unlimited amount of locations. Your router may have a limit of how many devices can be connected to one router.

4 My device can't be connected to network with App

- Make sure the device is under the config status (indicator light is flashing quickly)
- Make sure the Wi-Fi is available and not too far away from router
- Make sure the Wi-Fi password you input is correct

5 My device shows offline in my App

- Make sure the device is powered on
- Make sure the network is stable and the Wi-Fi name and password not modified. If not, add device again.
- If the network is normal, but it's still offline. Check if there are too many Wi-Fi connections. You can restart your router to check the status of the device.

*You can find much more useful information in the Help Center on App.

Technical Specifications

- Audio: Internal Speaker and Microphone
- Storage: supports up to 128G Micro SD card (not included)
- Wi-Fi: IEEE 802.11b/g/n, 2.4GHz(not compatible with 5GHz Wi-Fi networks)

Please read the instruction manual carefully before using the product

Thank you for purchasing Smart Camera. Get started using your new devices by downloading TuyaSmart, one convenient app that manages everything straight from your phone. Easily connect to your home Wi-Fi and control multiple devices from the touch of your fingertips

What's in the Box

- Smart Camera ×1
- USB Cable ×1
- User Manual ×1
- Mounting Bracket ×1 *
- Adapter ×1 *
- Screw bag ×1 *
- Punched sticker ×1 *
- Reset pin ×1 *

*: Different products have different accessories, please refer to physical packing.

Get Ready

- Know your Wi-Fi network and password
- Make sure your mobile device is running iOS® 9 or higher or Android™ 4.1× or higher
- Make sure you're connecting to a 2.4GHz Wi-Fi network (It can't connect to 5GHz networks)

1 Download the TuyaSmart app from App Store or Google Play.

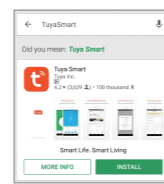
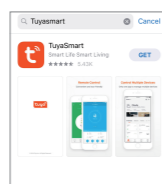

2 Register an account on your TuyaSmart app

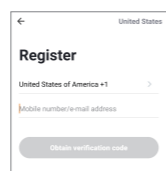

STEP 1. Enter your mobile phone number or email address.

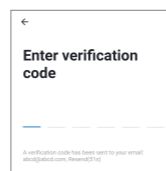

STEP 2. Enter the verification code and create a password.

3 Plug in

How do I reset my device?

- Press the Reset Button (as Pic 1) for several seconds until camera starts to beep.
- Optional: Insert Micro SD card as shown in Pic 2.

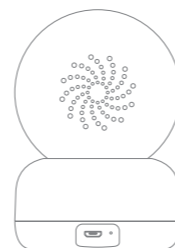

Pic 1

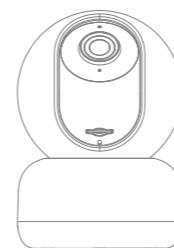

Pic 2

4 Add device

- Open TuyaSmart APP, click "+" on the top right corner of the page "HOME", then select "Smart Camera".
- Make sure the indicator light on the device is flashing red quickly, then press "Next Step".

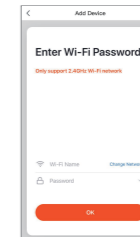
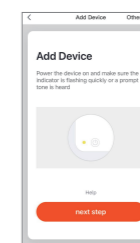

- Enter your "Wi-Fi network and password", click "OK".

4 Add device

- Read the instruction about "Scan with the camera", click "Continue".



- Scan the QR Code on your phone with camera. Heard a prompt tone, click "Heard the beep".

